

HOW TO SETUP IPSEC VPN			
OWNER	LCO IT DEPARTMENT	CREATED BY	Lionel Zumaran

1) Open Network Preferences

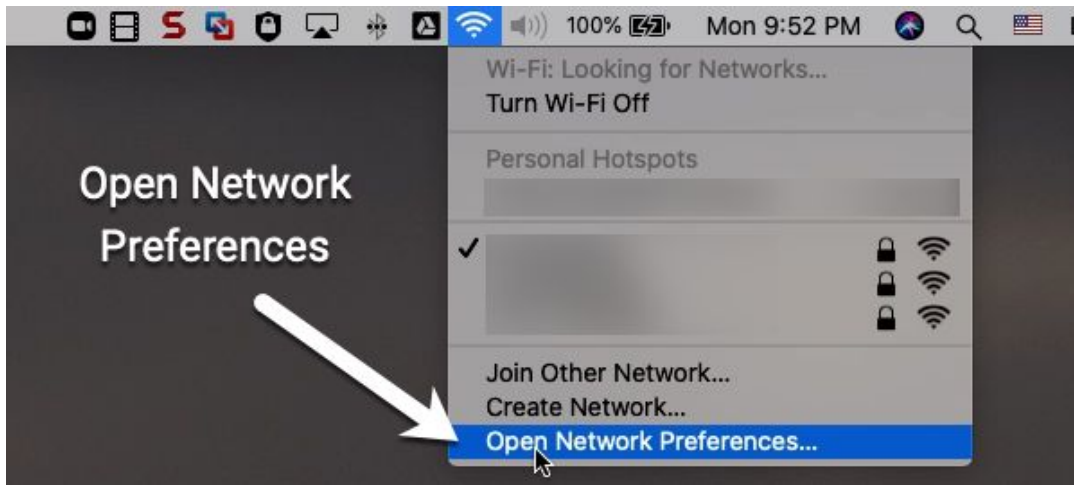

2) Create a new Service

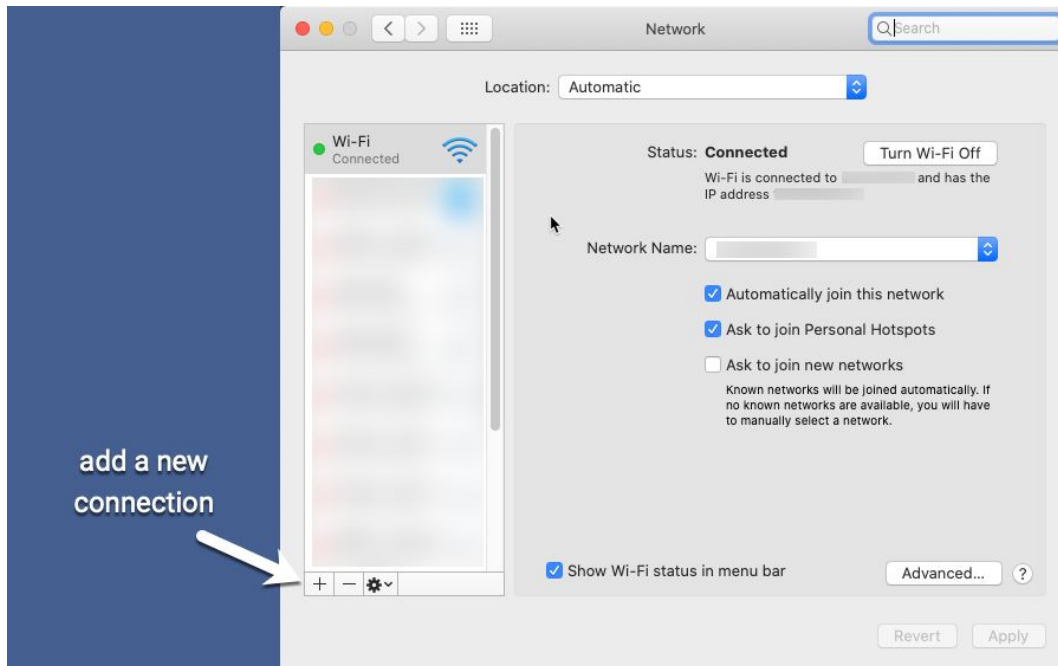

HOW TO SETUP IPSEC VPN			
OWNER	LCO IT DEPARTMENT	CREATED BY	Lionel Zumaran

3) Configure the new service

Select the interface and enter a name for the new service.

Interface: 1) Select VPN

VPN Type: 2) Select Cisco IPSec

Service Name: 3) Enter an optional Name

4) Click on create

4) Configure connection settings

Network

Location:

Status: **Not Connected**

Server Address:

Account Name: 1) Complete with information received by email

Password:

2) Click to complete settings

Show VPN status in menu bar

HOW TO SETUP IPSEC VPN			
OWNER	LCO IT DEPARTMENT	CREATED BY	Lionel Zumaran

5) Configure Authentication Settings

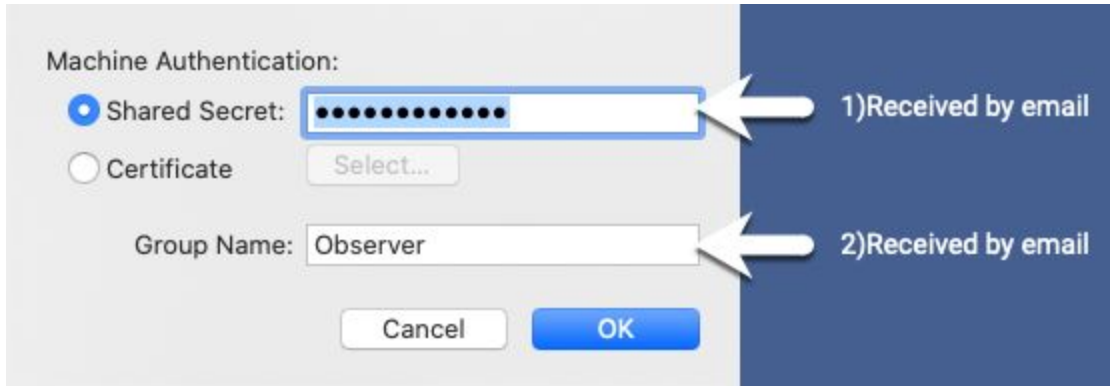

6) Apply Settings and connect

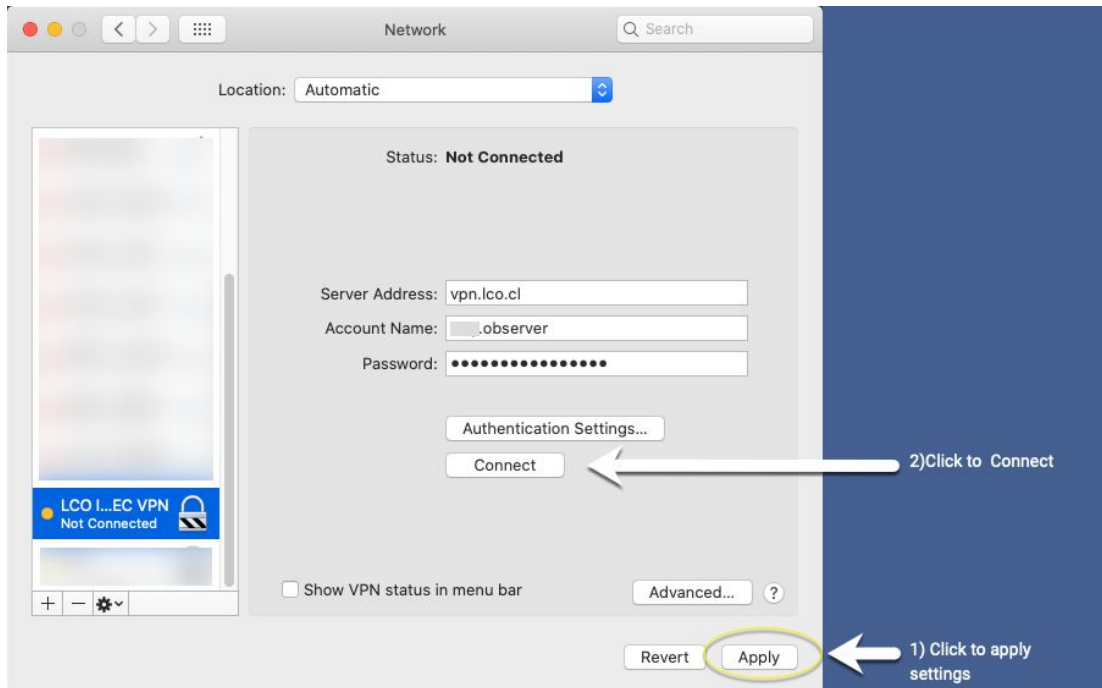

HOW TO SETUP IPSEC VPN			
OWNER	LCO IT DEPARTMENT	CREATED BY	Lionel Zumaran

7) Check connection Status

